

4 New Street, Mildenhall, Suffolk, IP28 7EN  
Tel: 01638 712132  
mildenhall@shiresestateagents.co.uk  
www.shiresresidential.com

**shires**

Estate & Letting Agents



## **The Street, Beck Row, Suffolk, IP28 8AD**

**Rent - £1,150 PCM      Deposit - £1,326**

This modern three bedroom semi-detached house is located in the village of Beck Row. The property has an open plan living area and is modern throughout, property is available now and ready to view!

- SEMI DETACHED HOUSE
- 3 BEDROOMS
- LARGE KITCHEN
- FAMILY BATHROOM & CLOAKROOM
- PARKING & GARDEN
- CLOSE TO RAF BASES
- OIL HEATING & ENERGY RATING - D
- APPROXIMATE SIZE - 721 SQ FT
- COUNCIL TAX BAND - B
- AVAILABLE NOW



Council Tax Band: B - EPC Rating: D 62

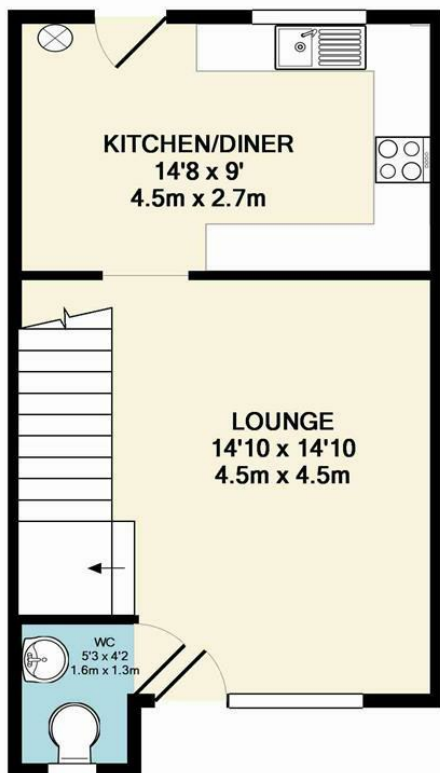

GROUND FLOOR  
APPROX. FLOOR  
AREA 361 SQ.FT.  
(33.6 SQ.M.)

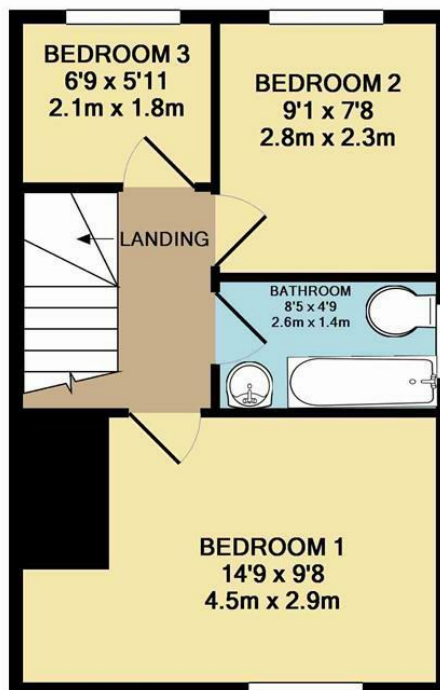

1ST FLOOR  
APPROX. FLOOR  
AREA 349 SQ.FT.  
(32.5 SQ.M.)

TOTAL APPROX. FLOOR AREA 711 SQ.FT. (66.0 SQ.M.)

Whilst every attempt has been made to ensure the accuracy of the floor plan contained here, measurements of doors, windows, rooms and any other items are approximate and no responsibility is taken for any error, omission, or mis-statement. This plan is for illustrative purposes only and should be used as such by any prospective purchaser. The services, systems and appliances shown have not been tested and no guarantee as to their operability or efficiency can be given

Made with Metropix ©2016

